

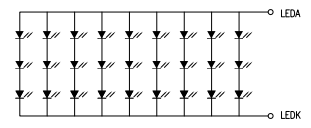

PIN ASSIGNMENT	
NO.	SYMBOL
1	LEDA
2	LEDA
3	VGH
4	VSL
5	UPDN
6	SHLR
7	LEDC
8	LEDC
9	AHDD
10	GND
11	MIP1_D3P
12	MIP1_D3N
13	GND
14	MIP1_D2P
15	MIP1_D2N
16	GND
17	MIP1_CLKP
18	MIP1_CLKN
19	GND
20	MIP1_D1P
21	MIP1_D1N
22	GND
23	MIP1_D0P
24	MIP1_D0N
25	GND
26	STBYB
27	LR51B
28	VDD
29	VDD
30	VCOM

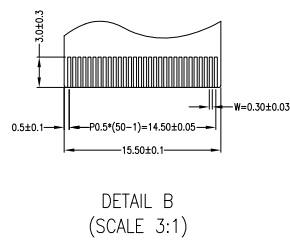
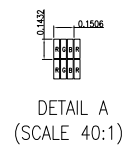
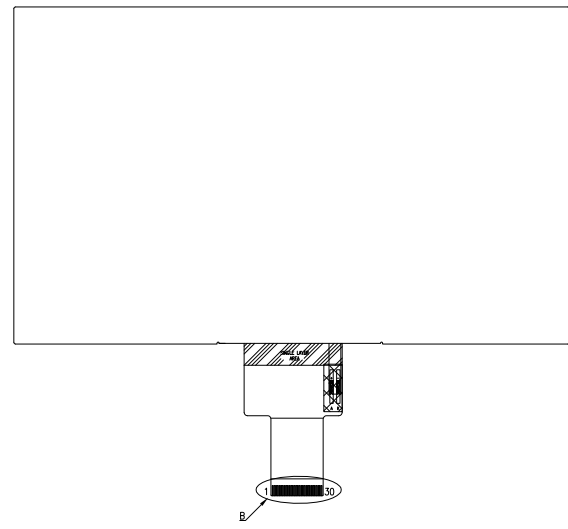
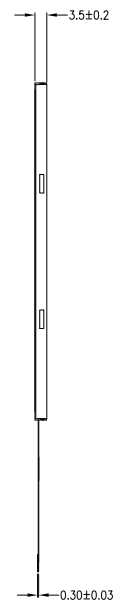
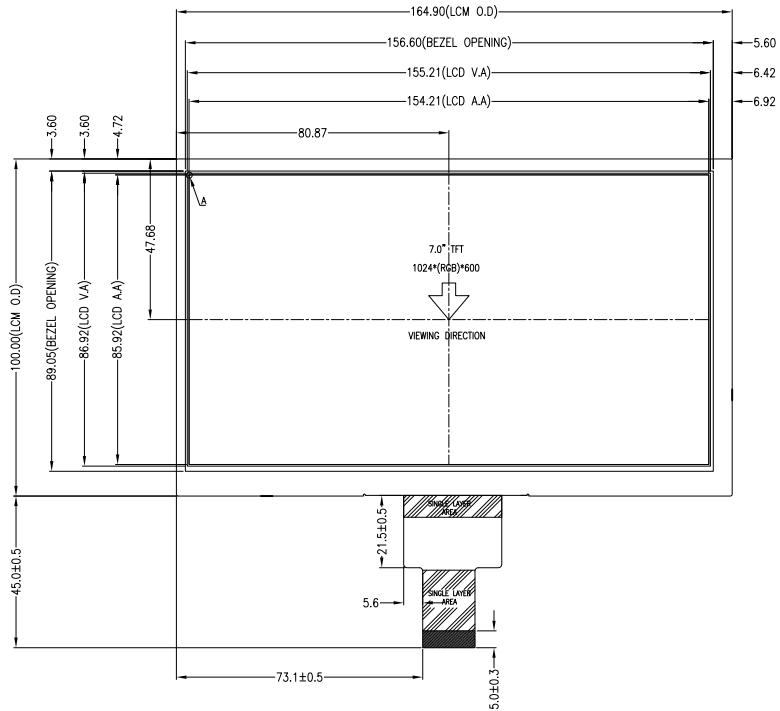

- NOTES:
1. DISPLAY TYPE: TFT, TRANSMISSIVE, NORMALLY WHITE.
  2. OPERATING VOLTAGE: VDD=3.3V.
  3. VIEWING DIRECTION: 12 O'CLOCK.
  4. DRIVER IC: EK79007AD+EK73217BCGA.
  5. OPERATING TEMP.: -20°C ~ 70°C.
  6. STORAGE TEMP.: -30°C ~ 80°C.
  7. LED BACKLIGHT: 27-CHIP WHITE LED, If=180mA, Vf=8.7V~9.9V.
  8. TOP POLARIZER SURFACE TREATMENT: ANTI-GLARE.
  9. SURFACE LUMINANCE: 400CD/M<sup>2</sup>(TYP.).
  10. GENERAL TOLERANCE: ±0.3MM.
  11. ROHS COMPLIANT.

MULTI-INNO TECHNOLOGY CO.,LTD.			
DRAWN BY:	RITA	2019.06.11	SCALE : 1/1
CHECKED BY:			UNIT: mm
APPROVED BY:			DESCRIPTION:
VERSION NO:	01		TFT MODULE

VER.	FIRST ISSUE	REVISER	DATE
01		RITA	2019.06.11
	REVISED DESCRIPTION		